

FIGURE 24. LONG-TERM OPERATION - ADJACENT TO ANY ROADWAY

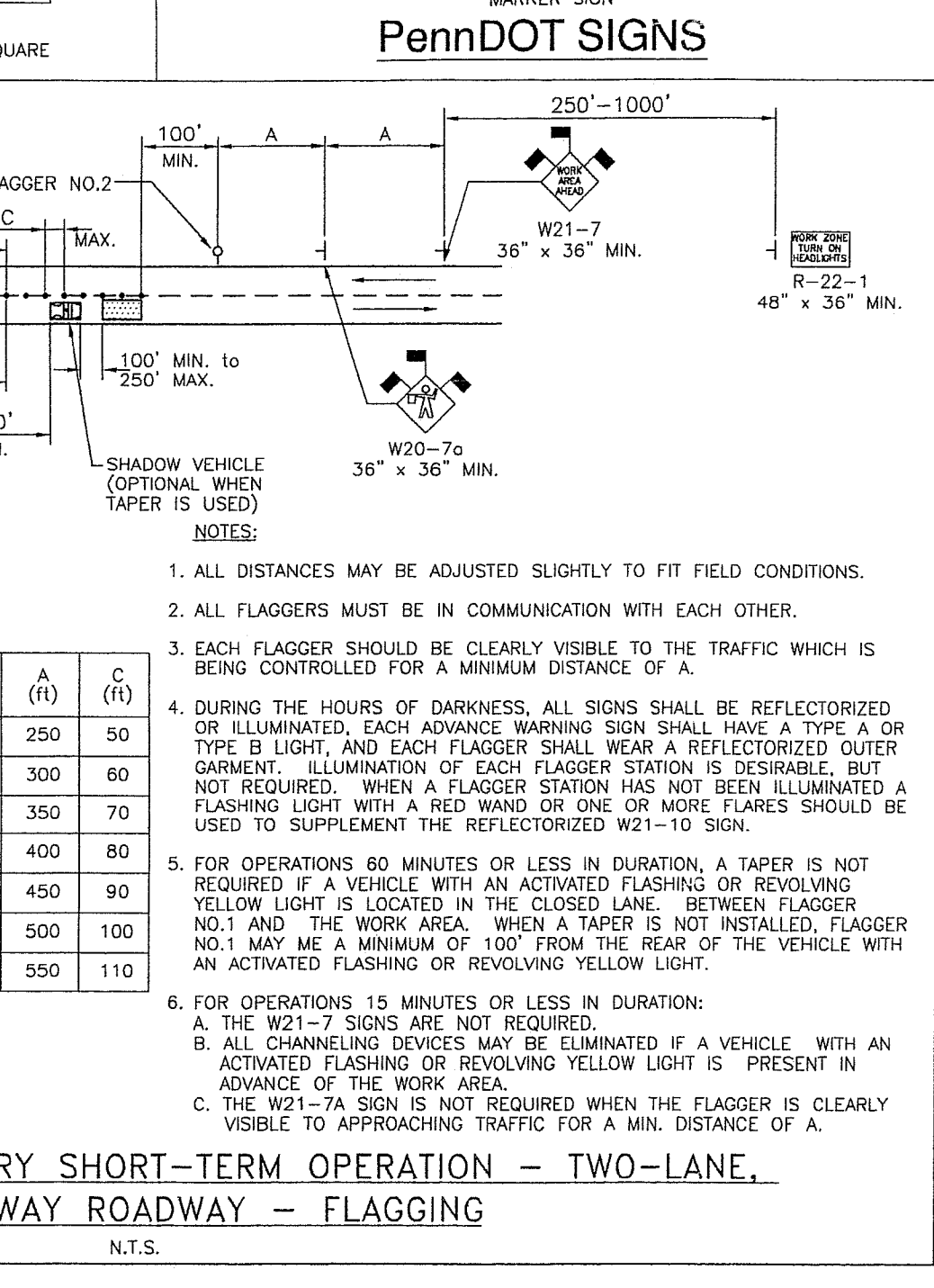
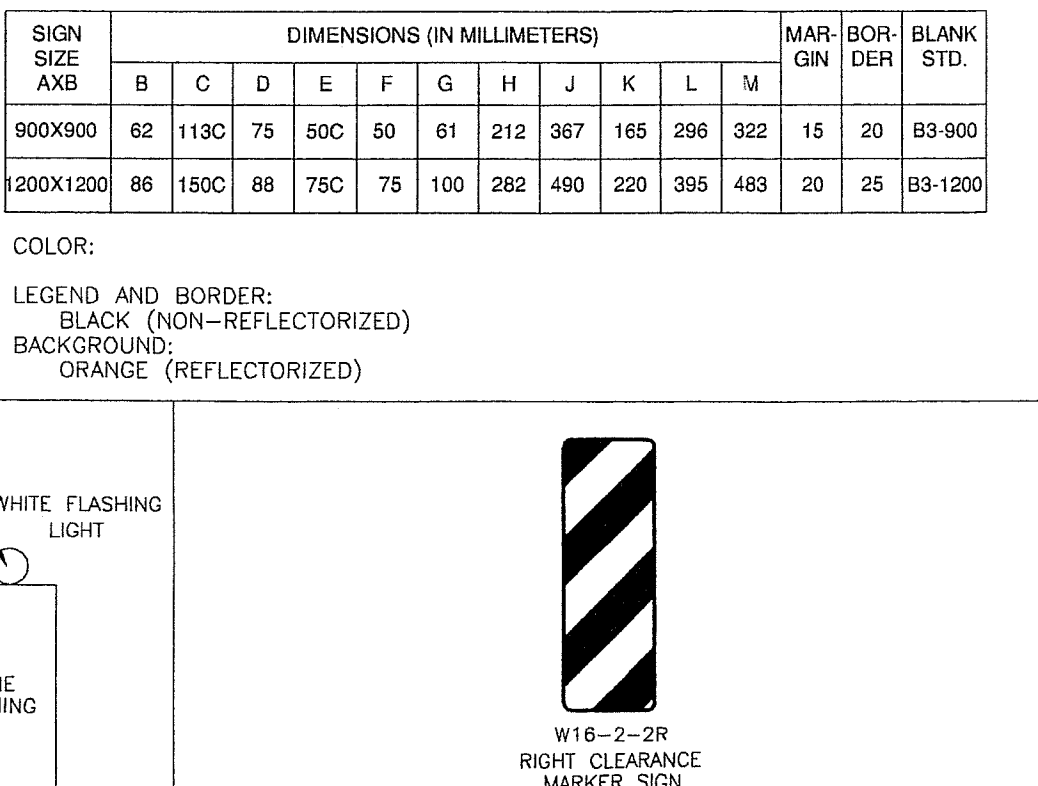
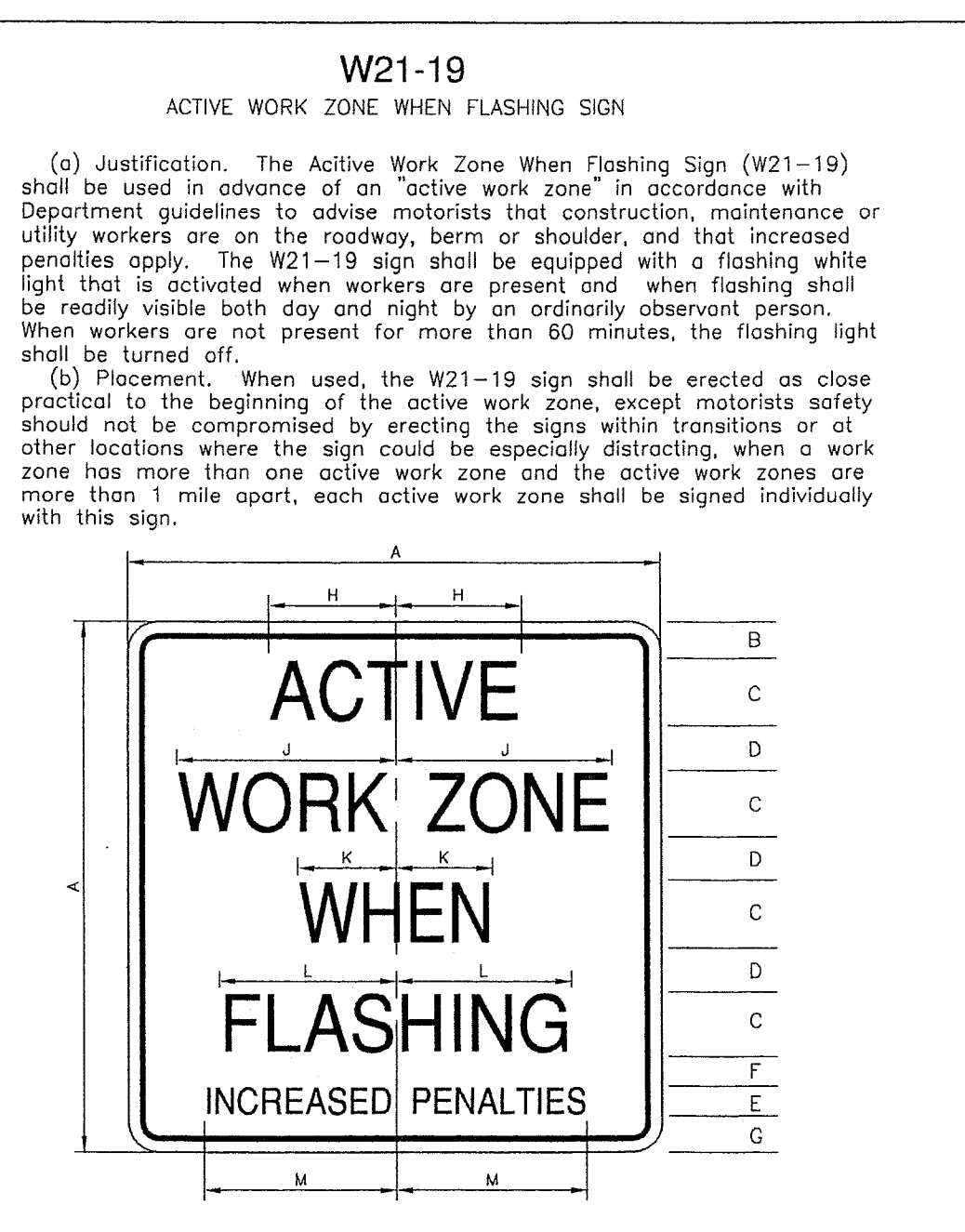

FIGURE 10a. STATIONARY SHORT-TERM OPERATION - TWO-LANE, TWO-WAY ROADWAY - FLAGGING

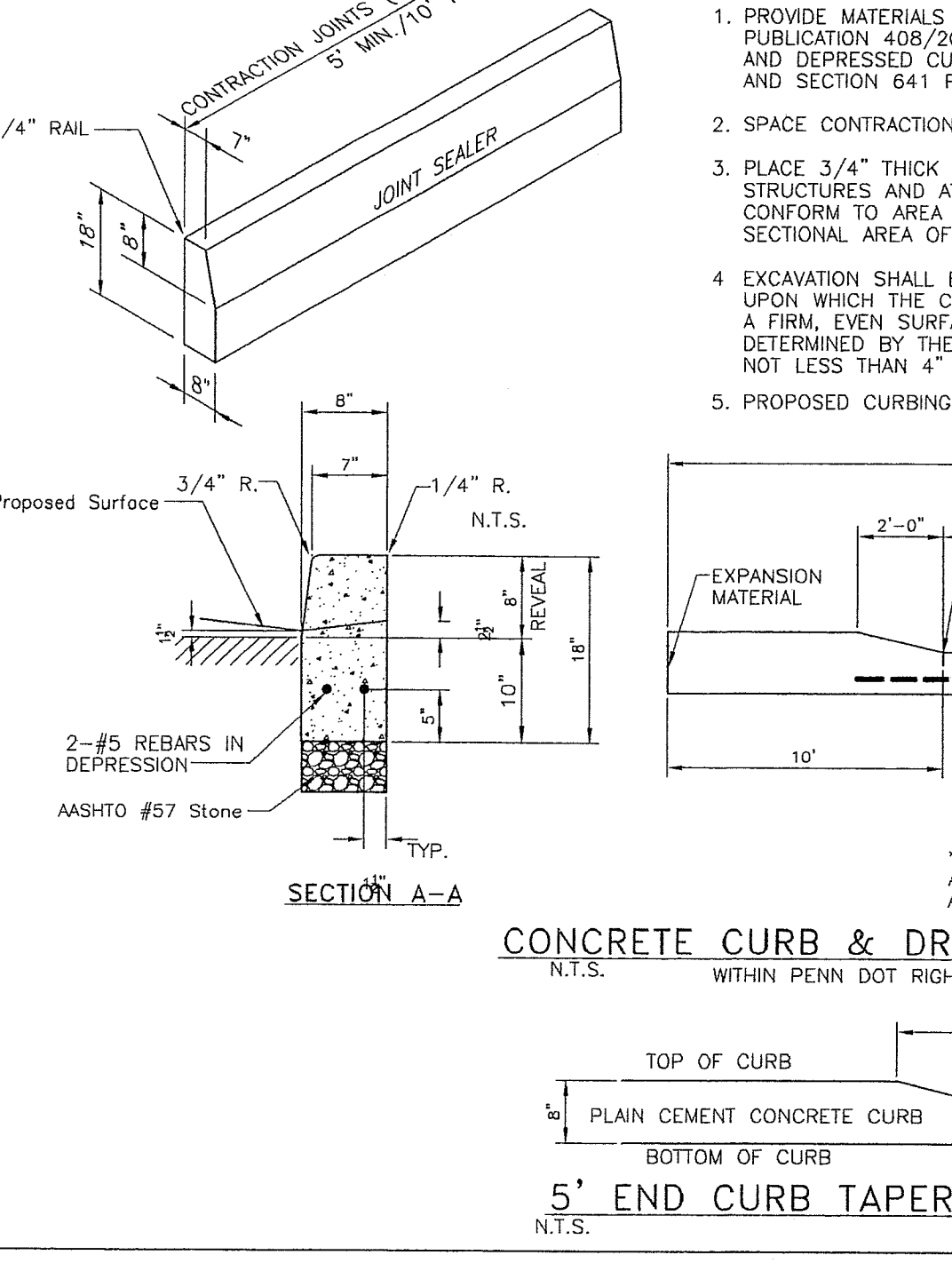
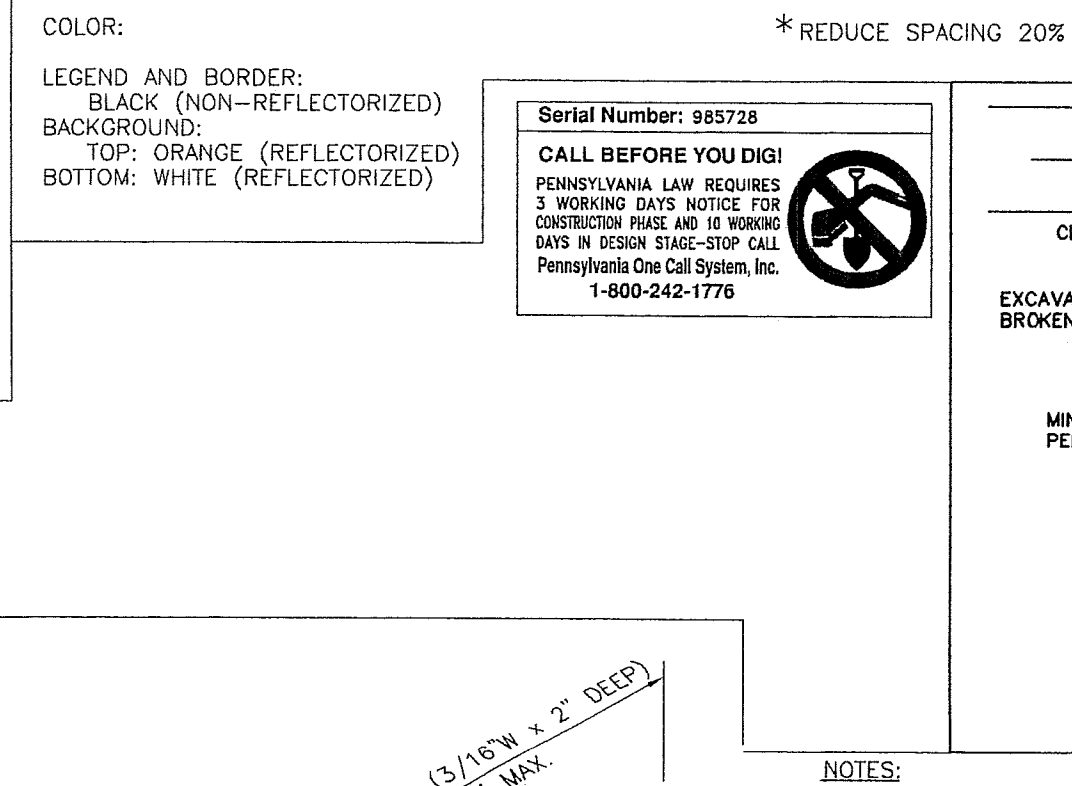
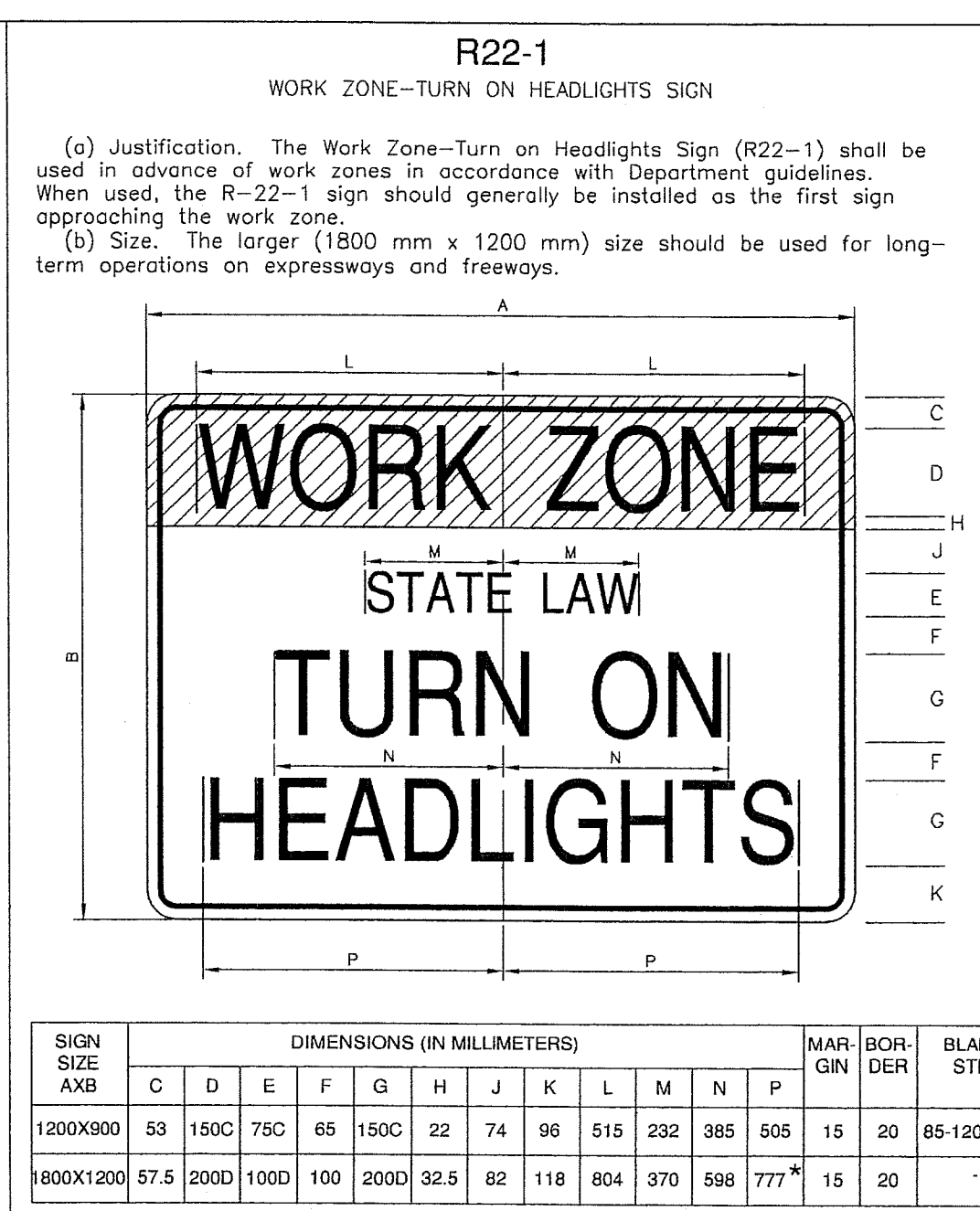

FIGURE 10b. STATIONARY SHORT-TERM OPERATION - TWO-LANE, TWO-WAY ROADWAY - FLAGGING

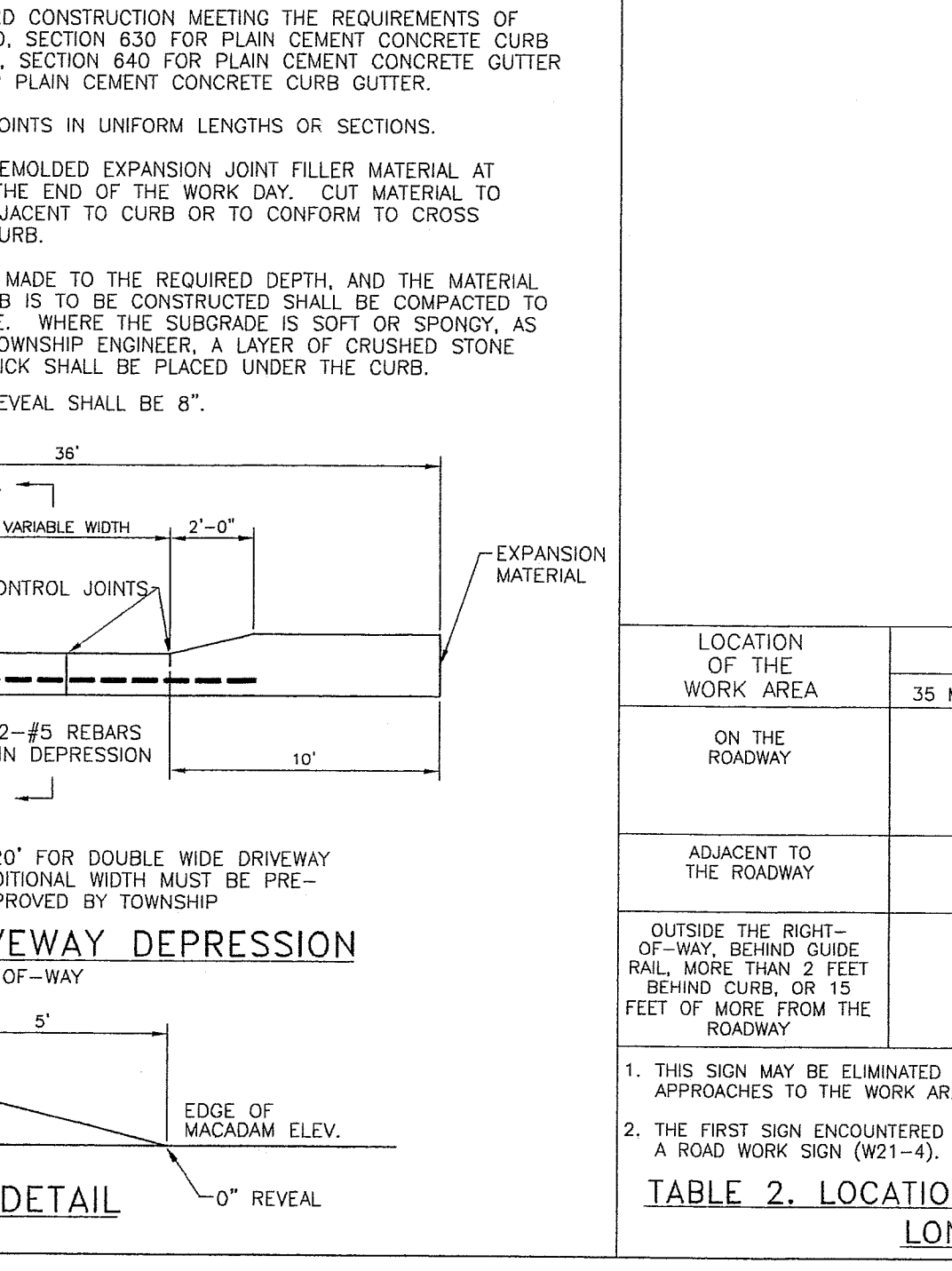
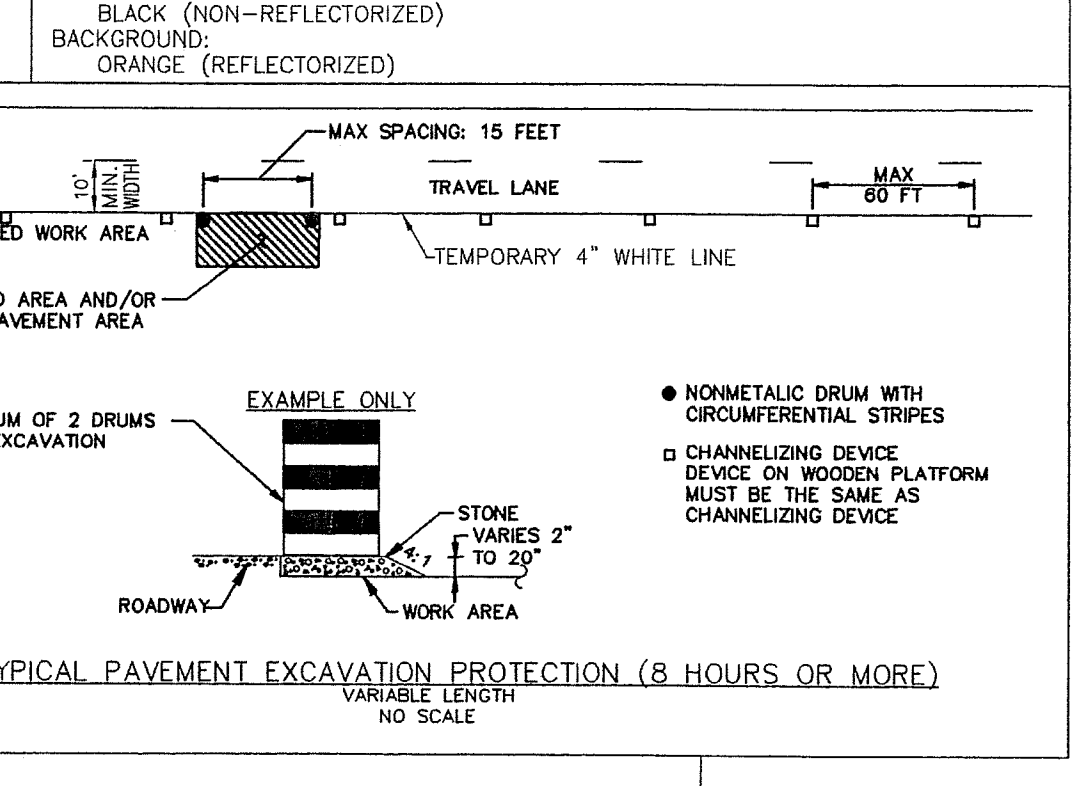
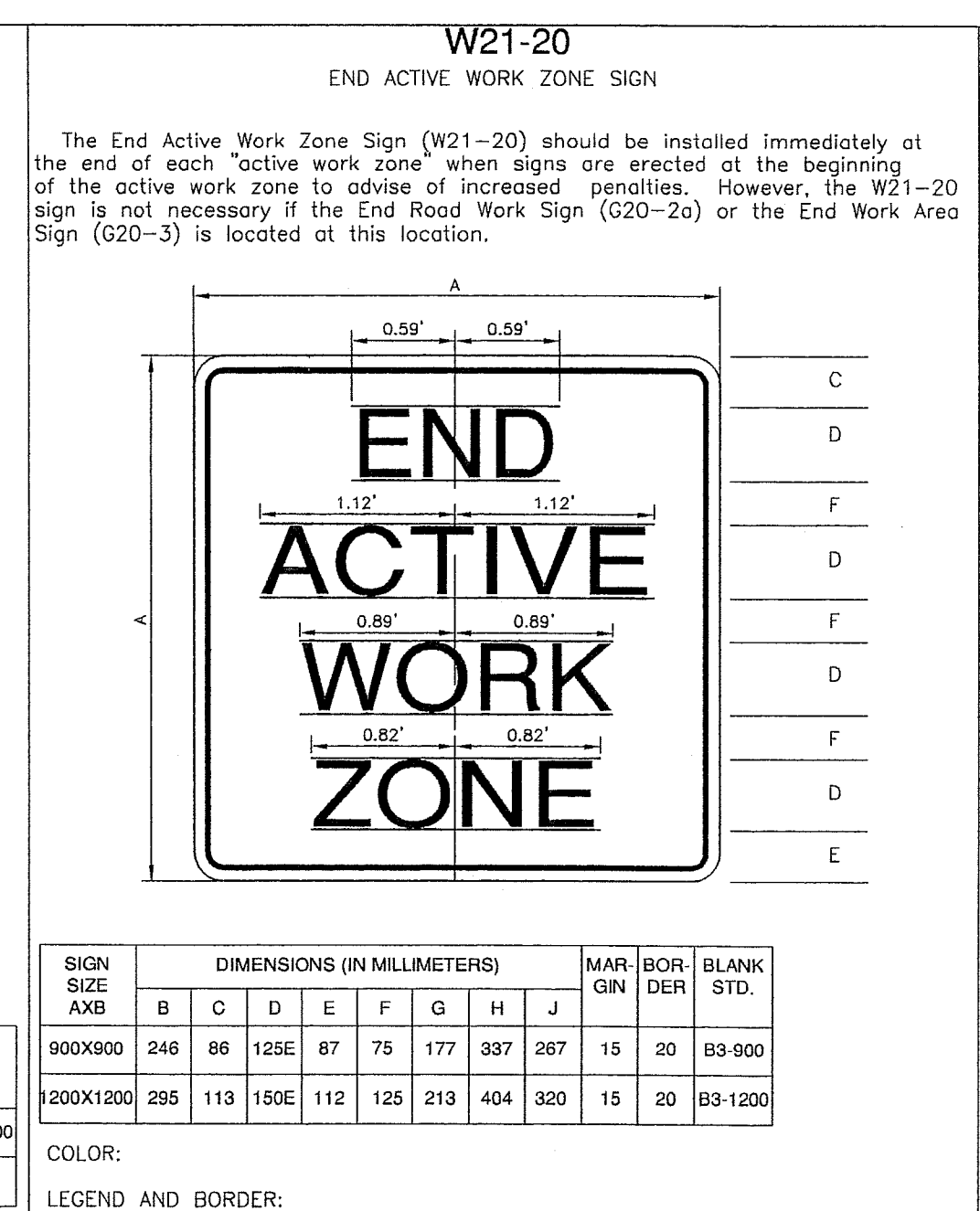

TABLE 2. LOCATION OF ADVANCE WARNING SIGNS FOR LONG-TERM OPERATIONS

GENERAL NOTES

- The responsibility for ensuring that all utility poles within the proposed paving are relocated outside of paved areas and shoulders shall be that of the permittee. The utility poles must be relocated before the start of any paving operations.
- All utility relocations must be in accordance with PennDOT Design Manual Part 5. All utility relocation permits take precedence over the utility relocation positions shown on the HOP plans.
- A minimum 2' clearance is required between the face of the relocated utility poles and the face of curb.
- No unsuitable material is to be used in any portion of the roadway construction. Remove any subgrade that cannot be properly compacted and that is unsuitable material. Undercutting and/or subgrade stabilization may be required.
- The legal width of S.R. 4046 is determined to be 33 feet wide.
- All existing pavement markings which are no longer appropriate shall be eradicated by the permittee. The permittee shall place all required new pavement markings.
- Pavement Marking - All long line pavement markings must be epoxy. All short lines and pavement marking legends on bituminous pavement must be hot thermoplastic.
- No traffic restrictions or lane closures are permitted between the hours of 6:00 AM to 6:00 PM and 3:00 PM to 6:00 PM, Monday through Friday and legal holidays.

PER ACT 229 OF 2002, ADDITIONAL TRAFFIC CONTROL DEVICES IN HIGHWAY WORK ZONES

- A "Work Zone-Turn on Headlights" sign, R22-1, sized 48"x36" shall be installed 250'-1000' before the first sign as specified by Publication 203 (smaller spacing on low speed roads, greater on high speed roads).
- An "Active Work Zone When Flashing" sign, W21-19, sized 36" or 48" square sizes (same as other warning signs), shall be installed as close to practical to the beginning of the active work zone, and be placed in advance of any flag person. A white flashing light should be attached to the W21-19 sign.
- An "End Active Work Zone" sign, W21-20, sized 36" or 48" square sizes (same size as other warning signs), shall be placed immediately at the end of the active work zone. This is not required if an "End Road Work" sign (G20-2A), or an "End Road Work" sign (G20-3) is used at the same location.
- Maintenance and Protection of Traffic during construction shall be in accordance with applicable Figures 10a and 24 in PennDOT publication 203, "Work Zone Traffic Control", May 2002, or most current.

GENERAL CONSTRUCTION SEQUENCE

- Install advance warning signs along east-bound lane of SR4012 (use Figure 24).
- Install channelizing devices along east-bound lane of SR4012 (use Figure 24).
- Install storm piping, inlets, underdrains and curb along east-bound lane.
- Where work encroaches the travel lane, install channelizing devices in accordance with Figure 10a.
- Remove channelizing devices after completion of work along east-bound side of SR4012.
- Install bituminous base course on area to be widened (use Figure 24).
- Install bituminous overlay over east-bound lane and shoulder of SR4012 as depicted on the plans. Utilize Figure 10a during paving operations.
- After work is completed, the work zone traffic control scheme may be dismantled. The channelizing devices which surround the worksite should be removed first, followed by flaggers which may have been used. The work area signing may then be removed and normal traffic patterns restored.

This document, and all reports, plans, specifications, field data, notes and other documents, including all documents on electronic media, prepared by LANDMARK Engineers, Inc. as instruments of service shall remain the sole and exclusive property of LANDMARK Engineers, Inc. The information contained herein is licensed only for limited use by the intended recipient and no license, permission or authority is extended, directly or implied, to any party without the written authorization of LANDMARK Engineers, Inc.

GENERAL CONSTRUCTION SEQUENCE

- Install advance warning signs along east-bound lane of SR4012 (use Figure 24).
- Install channelizing devices along east-bound lane of SR4012 (use Figure 24).
- Install storm piping, inlets, underdrains and curb along east-bound lane.
- Where work encroaches the travel lane, install channelizing devices in accordance with Figure 10a.
- Remove channelizing devices after completion of work along east-bound side of SR4012.
- Install bituminous base course on area to be widened (use Figure 24).
- Install bituminous overlay over east-bound lane and shoulder of SR4012 as depicted on the plans. Utilize Figure 10a during paving operations.
- After work is completed, the work zone traffic control scheme may be dismantled. The channelizing devices which surround the worksite should be removed first, followed by flaggers which may have been used. The work area signing may then be removed and normal traffic patterns restored.

No.	Revision/Issue	Date
2	Revised Per Township Engineers Letter Dated August 22, 2005	08-31-05
1	Revised Per Township Engineers Letter Dated June 23, 2005	07-01-05

Firm Name and Address
LANDMARK ENGINEERS, INC.
555 SOUTH SECOND STREET
BUILDING B, SUITE 300
COLLEGEVILLE, PA 19426
TEL: (610)489-4010 FAX: (610)489-5510

Sheet No.
13 of 13
Drawn By
S.P.K.
Checked By
A.T.S.
Drawing Title
Penn DOT Details

Project Name and Address
Evergreen Road Self Storage
Limerick Township
Montgomery County, PA

Project
LO68.001
Date
4-08-05
Drawing No.
13
Scale
No Scale